

SCHINELLA.



2/3 Macklin Street Parkside SA

2  1  1 

Apply by setting up your profile on tenant options:
<https://app.tenantoptions.com.au/>

Enjoy living a city-fringe lifestyle. Ride your bike into the City Centre or stroll to the many cafes and restaurants located at your doorstep. Shop at the local boutiques on nearby Unley and King William Roads or visit the community events held in Victoria Park and the Fullarton Markets - This trendy cosmopolitan precinct offers a great vibe!

Located on a quiet one-way street, this ground floor unit sits among tranquil grounds and has been updated and renovated throughout, with new carpet and blinds (to be installed), neutral tones and light and bright living spaces.

Type : Unit

View : <https://www.schinellaproperty.com.au/8335211>



Amanda Bebbington
(08) 8294 4484

[For full version visit the website](https://www.schinellaproperty.com.au)

<https://www.schinellaproperty.com.au>

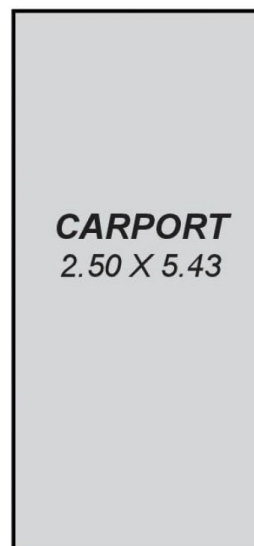
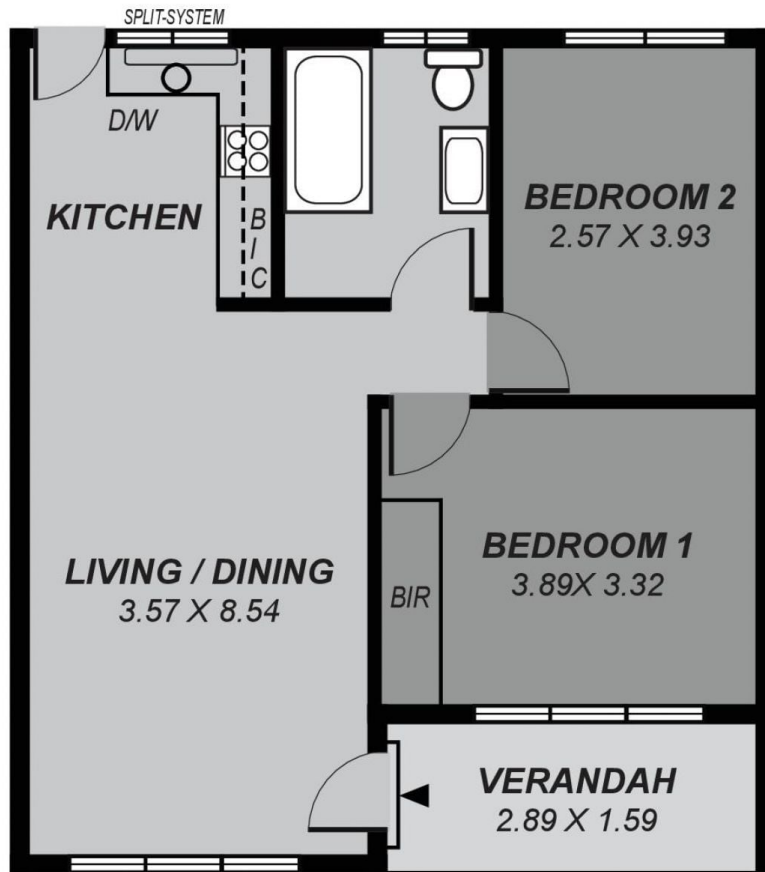

*This drawing is for illustration purposes only .
All measurements are approximate and details intended
to be relied upon should be independently verified.*

Area	m ²
Living:	56.73
Carport:	13.58
Verandah:	4.60
Total:	74.91