

# SCHINELLA.



**10a Pickering Street Brompton SA**

3 2 2

This townhouse is certainly not your typical build at all - it has been fitted out with luxury fittings and quality features throughout that you just don't find in properties these days.

Situated in the ever popular suburb of Brompton which is within walking distance to the free Tram, the CBD and a stones throw from the local Brompton Hotel and Plant 4 - offering you the enviable cosmopolitan lifestyle that everyone is looking for.

This very well thought out floor plan makes the property flow front to back and top to bottom. Neutral tones throughout is a great blank canvas to add your own style.

The lower level has a wooden feature door with crim safe

[For full version visit the website](#)

**Type** : Townhouse

**View** : <https://www.schinellaproperty.com.au/7963036>



**Amanda Bebbington**  
(08) 8294 4484



**Renee Jackson**  
8294 4484

<https://www.schinellaproperty.com.au>

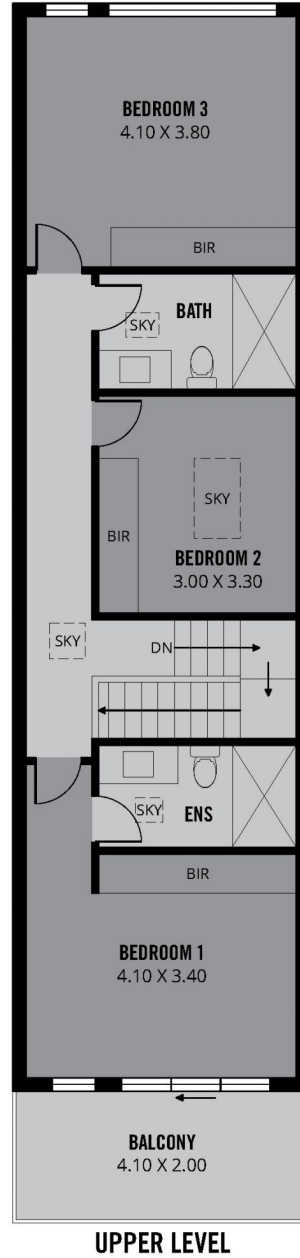
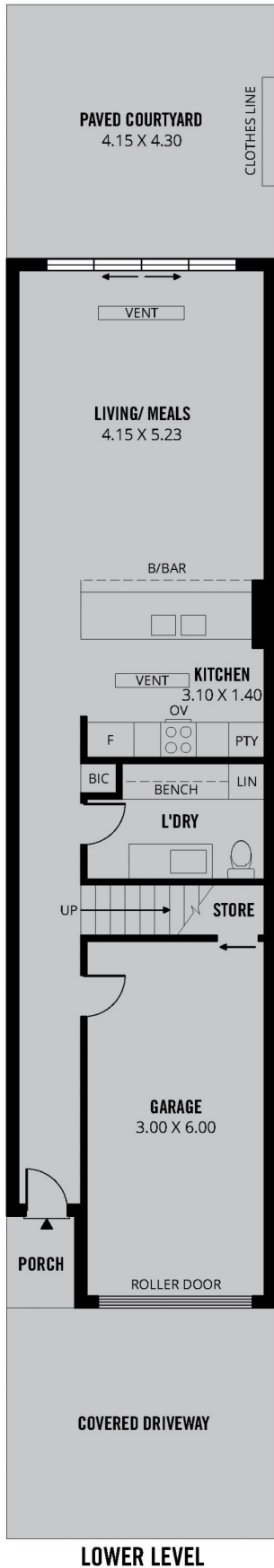

**181m<sup>2</sup>**

**TOTAL**

133m<sup>2</sup>

Living

20m<sup>2</sup>

Garage

8m<sup>2</sup>

Balcony

18m<sup>2</sup>

Paved  
Courtyard

2m<sup>2</sup>

Porch

Scale in metres. This drawing is for illustration purposes only. All measurements are approximate and details intended to be relied upon should be independently verified.

Produced by **The Fotobase Group**