

SCHINELLA.



24 Junction Lane Mile End SA

3  1  2 

A great opportunity to live in this modern townhouse in a sought-after city-fringe location.

Positioned in a private and secure group facing Junction Lane, just 2km from the CBD. Close to public transport makes it an easy commute to work, University or TAFE. Enjoy a cosmopolitan lifestyle and walk to many shops, restaurants and cafes along Henley Beach Road.

Downstairs features a stylish new kitchen with dining area, separate spacious lounge, laundry with second toilet, private courtyard with attractive cottage garden, lock-up garage and car space for second vehicle.

Upstairs has three generous size bedrooms with built-in

[For full version visit the website](#)

Type : House

View : <https://www.schinellaproperty.com.au/7896659>



Amanda Bebbington
(08) 8294 4484

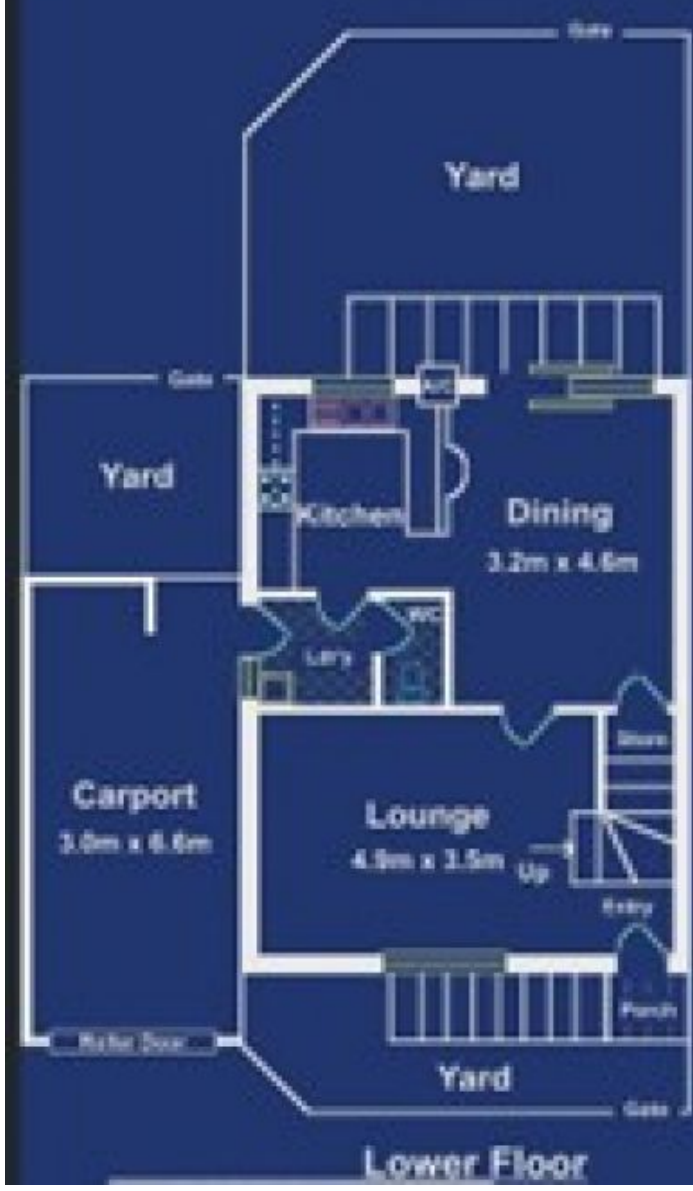

Area	M ²
Lower Floor	54.93
Upper Floor	54.93
Carport	19.80
Porch	1.19
Total Approx	130.85



Lower Floor

Upper Floor