

SCHINELLA.



72b Canterbury Ave Payneham South SA

4  2  2 

Perfectly positioned in the heart of this popular locale, this magnificent family residence offers much more than meets the eye.

Spread over two main levels, the home offers large rooms, high ceilings, multiple living areas and high quality finishes throughout, culminating in an impressive residence designed for modern family living.

The lower level features a grand hallway that leads to the master bedroom suite, complete with luxurious ensuite and walk-in robe. This level also houses the large laundry with plenty of storage space, & half bathroom. The end of the hall opens to the kitchen and the huge living and dining space.

The gourmet kitchen features stone benchtops, convenient breakfast counter, integrated dishwasher, and its' own

Type : Semi Detached
Price : \$ 1,275,000
Land Size : 441 sqm
View : <https://www.schinellaproperty.com.au/7153001>



Damian Popowycz
0413 026 026



Mladen Djuric
0432259123

[For full version visit the website](https://www.schinellaproperty.com.au)

<https://www.schinellaproperty.com.au>

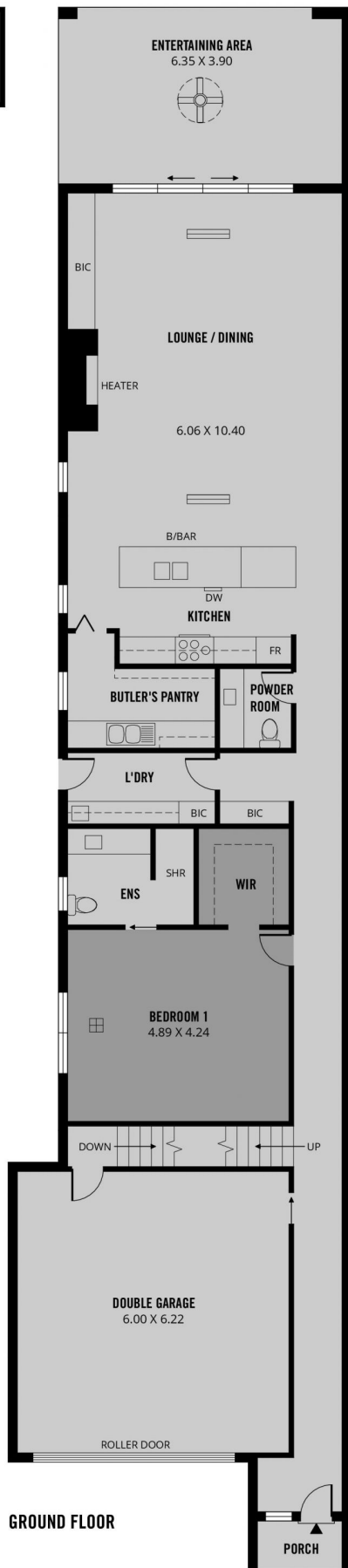
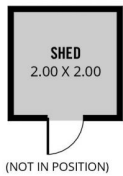

GROUND FLOOR

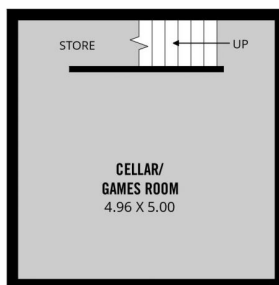

LOWER FLOOR

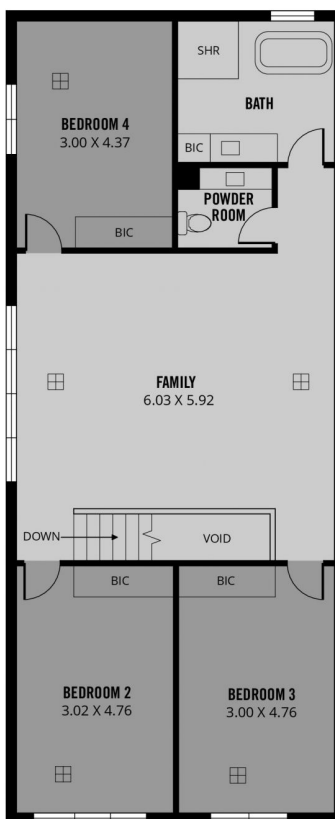

FIRST FLOOR

355m²
TOTAL

283m²
Living

5m²
Shed

40m²
Double Garage

2m²
Porch

25m²
Entertaining Area



Scale in metres. This drawing is for illustration purposes only. All measurements are approximate and details intended to be relied upon should be independently verified.