

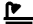

SCHINELLA.



3 Morphett Place Mawson Lakes SA

4  2  2 

Architecturally inspired to deliver first-class living, this spectacular home has been custom built to perfection. One of only a handful with exclusive park frontage, just metres from the Lake.

Presented with pure class and elegance, enjoy 332sqm of luxury design across 2 spacious levels.

Families will instantly appreciate the premium look and feel. The ground floor showcases a bright open plan living and dining area, a space elegantly styled with gas fireplace. Infusing light and space, the courtyard transforms seamlessly into an entertainer's paradise and is the perfect setting to relax and unwind.

Type : House
Price : \$ 870,000
Building Size : 332 sqm
View : <https://www.schinellaproperty.com.au/6827850>



Marco Schinella
08 8294 4484

[For full version visit the website](https://www.schinellaproperty.com.au)

<https://www.schinellaproperty.com.au>

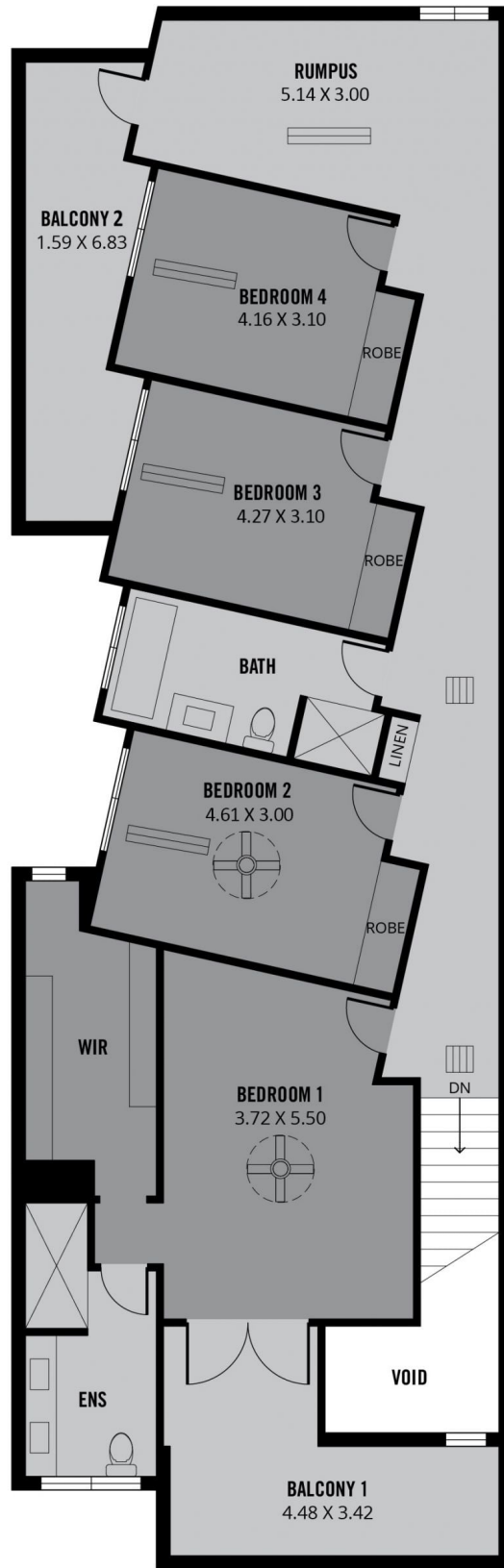
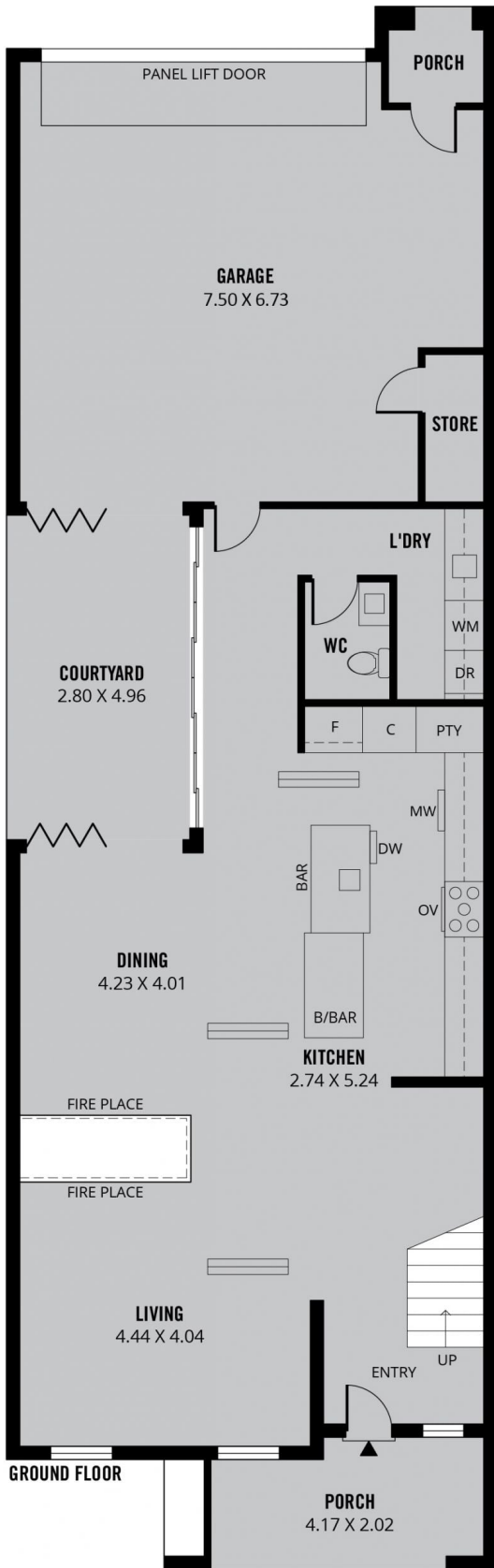

332m²

TOTAL

Scale in metres. This drawing is for illustration purposes only. All measurements are approximate and details intended to be relied upon should be independently verified.

Produced by **The Fotobase Group**