

SCHINELLA.

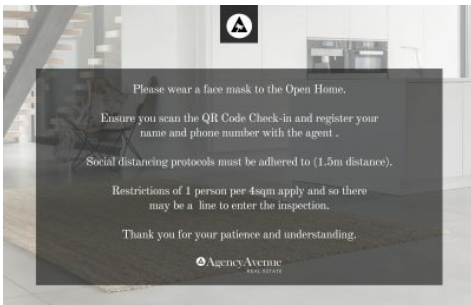

145A Military Road Henley Beach South SA

3 2 1

Perfectly located in the popular suburb of Henley Beach South, with commanding street appeal this home is ideally positioned at the tranquil end of Military Rd.

With a short stroll to the esplanade and the beautiful Henley Beach, zoning to Henley High School, this one is a must see.

If you are looking for a perfect low maintenance property close to the beach, this property offers 3 double bedrooms and 2 bathrooms. Neutral tones have been thoughtfully selected throughout to allow plenty of scope for you to add your own decorative touches.

The beautiful white kitchen is well planned with plenty of

[For full version visit the website](https://www.schinellaproperty.com.au/6793311)

Type : House

View : <https://www.schinellaproperty.com.au/6793311>



Tami Stolarski
8294 4484



Renee Jackson
8294 4484

<https://www.schinellaproperty.com.au>

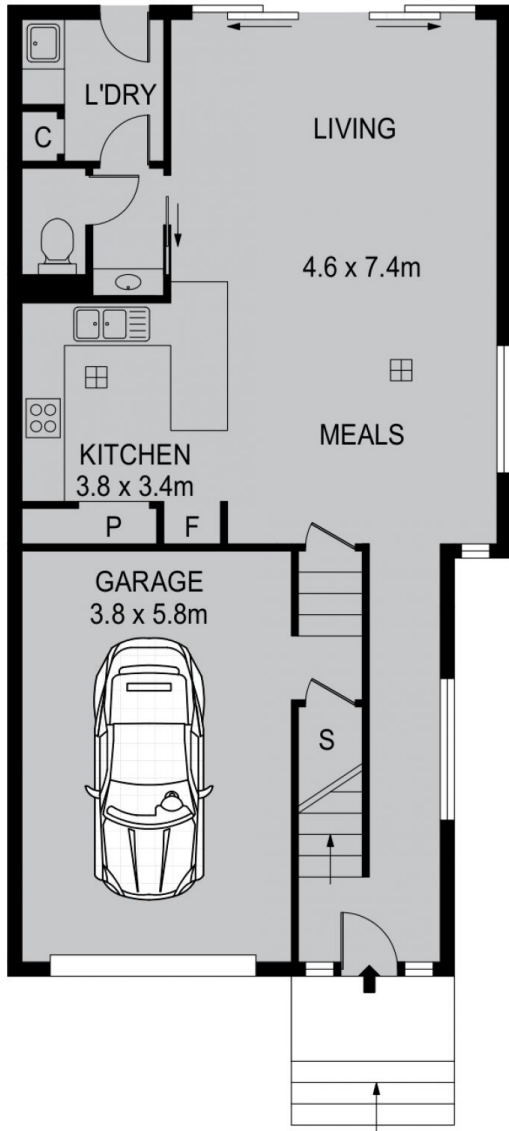

GROUND FLOOR

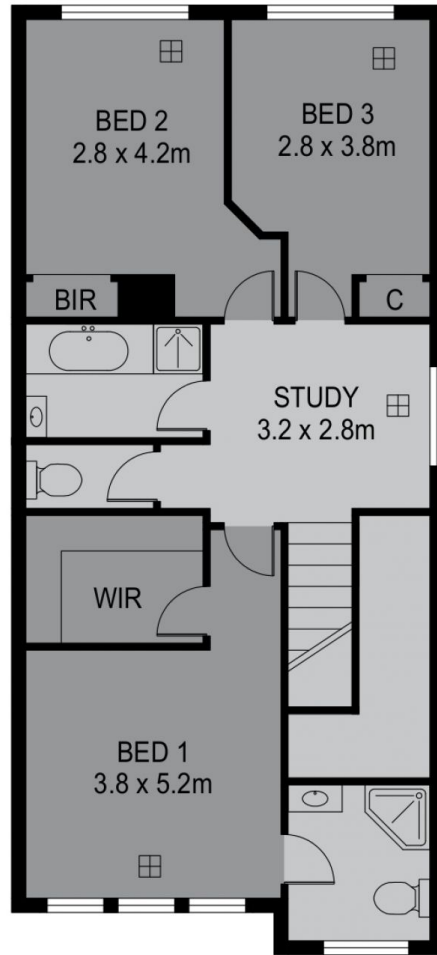

FIRST FLOOR



Scale in metres. Indicative only. Dimensions are approximate. All information contained herein is gathered from sources we believe to be reliable. However we cannot guarantee its accuracy and interested persons should rely on their own enquiries

INT : 133m²
 GARAGE : 12m²

145A Military Road, Henley Beach