

SCHINELLA.



11 Gill Road Lightsview SA

3 3 2

This contemporary 2018 built, Torrens Titled residence is only 8km from the city. It offers easy access to public transport and is close to community parks, cafes, restaurants and schools - the lifestyle that only this beautiful precinct can offer at such great value.

Perfect for home owners or astute investors (approx 5% rental return pa), this property includes many added features and upgrades that you just wont find in neighbouring properties. It is bright, vibrant and full of style and most importantly offers secure living.

Based on European style living, there is a flexible floorplan that flows across 3 levels. The secure entrance features a tiled courtyard at the bottom of the impressive light-well.

[For full version visit the website](https://www.schinellaproperty.com.au/6634789)

Type : House
Price : \$ 531,000
Building Size : 200 sqm
View : <https://www.schinellaproperty.com.au/6634789>



DeArna Schinella
08 8294 4484



Pat Schinella
08 8294 4484

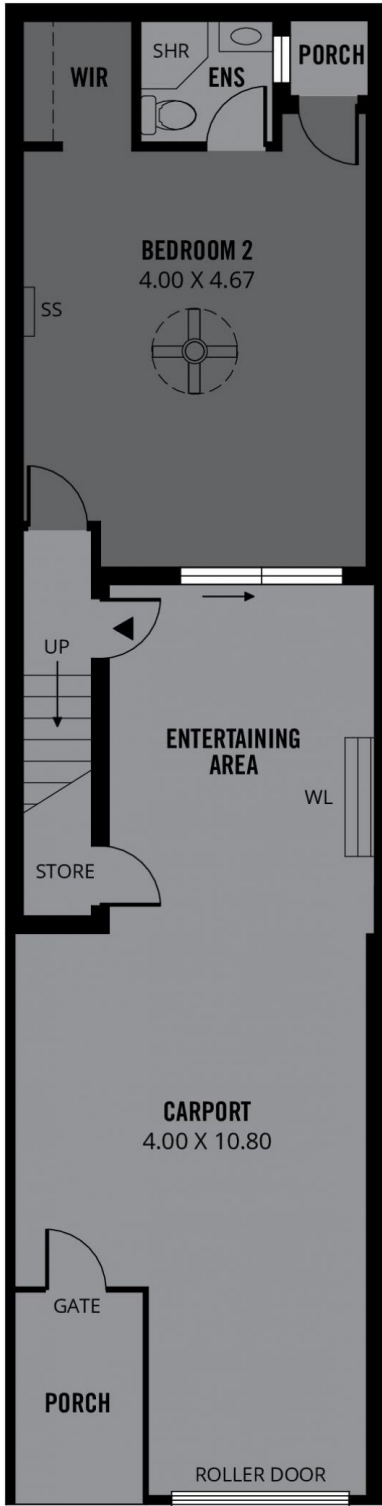

GROUND FLOOR

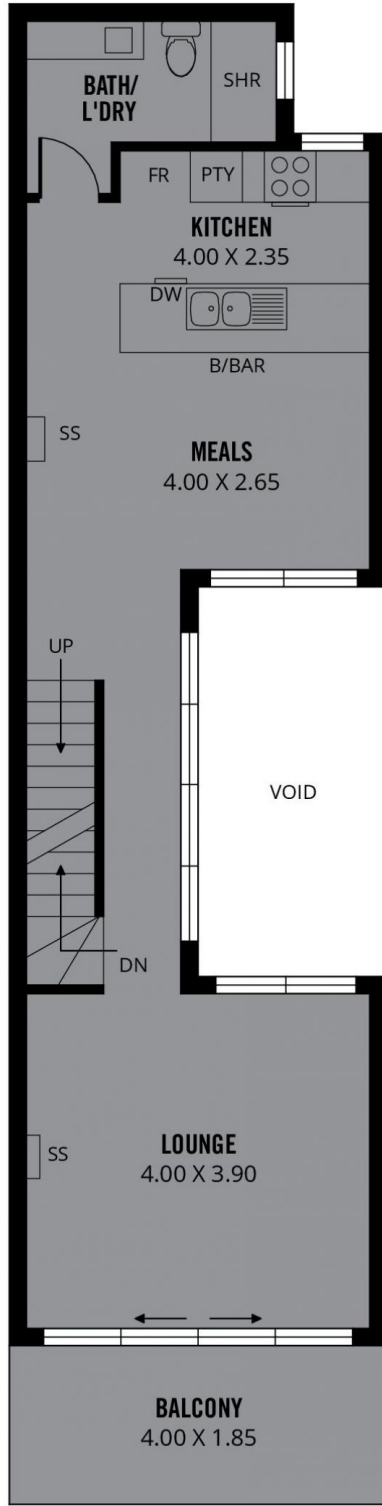

FIRST FLOOR

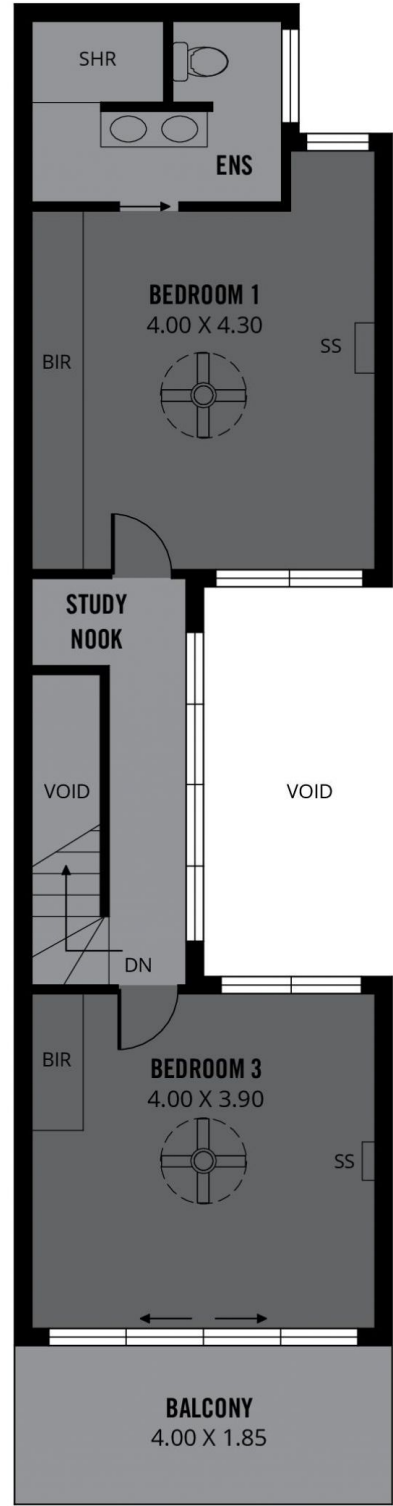

SECOND FLOOR



TOTAL



Living

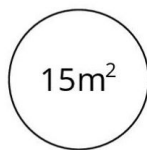

Balcony



Entertaining
Area/ Carport

Scale in metres. This drawing is for illustration purposes only. All measurements are approximate and details intended to be relied upon should be independently verified.

Produced by **The Fotobase Group**