

# SCHINELLA.

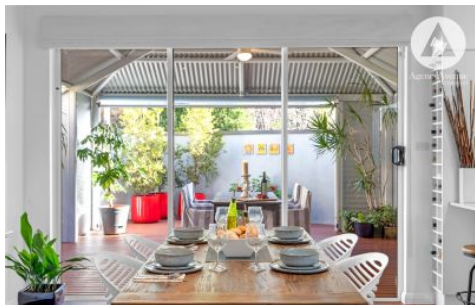

14 Woodfield Avenue Warradale SA

3 🏠 2 🚗 4 🚗

You will not be disappointed when you inspect this home. As this property will appeal to many looking for their next home. If you are looking to downsize to a smaller allotment where you can lock and leave while still having plenty of garage space for up to 4 cars or if you have a caravan or boat then this is the perfect property for you.

**Type** : House  
**Price** : \$ 637,000  
**Land Size** : 343 sqm  
**View** : <https://www.schinellaproperty.com.au/6302619>

Nestled neatly in the sought after suburb of Warradale where everything is at your finger tips and located in the ever popular Brighton High school zone.

This faultless and unique home is coming to the market for the first time in many years. It is the pride and joy of its current owners and has been meticulously maintained and cared for over the years. Surpassing many other homes in



**Jennifer Wilson-Gage**  
08 8294 4484

[For full version visit the website](https://www.schinellaproperty.com.au)

<https://www.schinellaproperty.com.au>

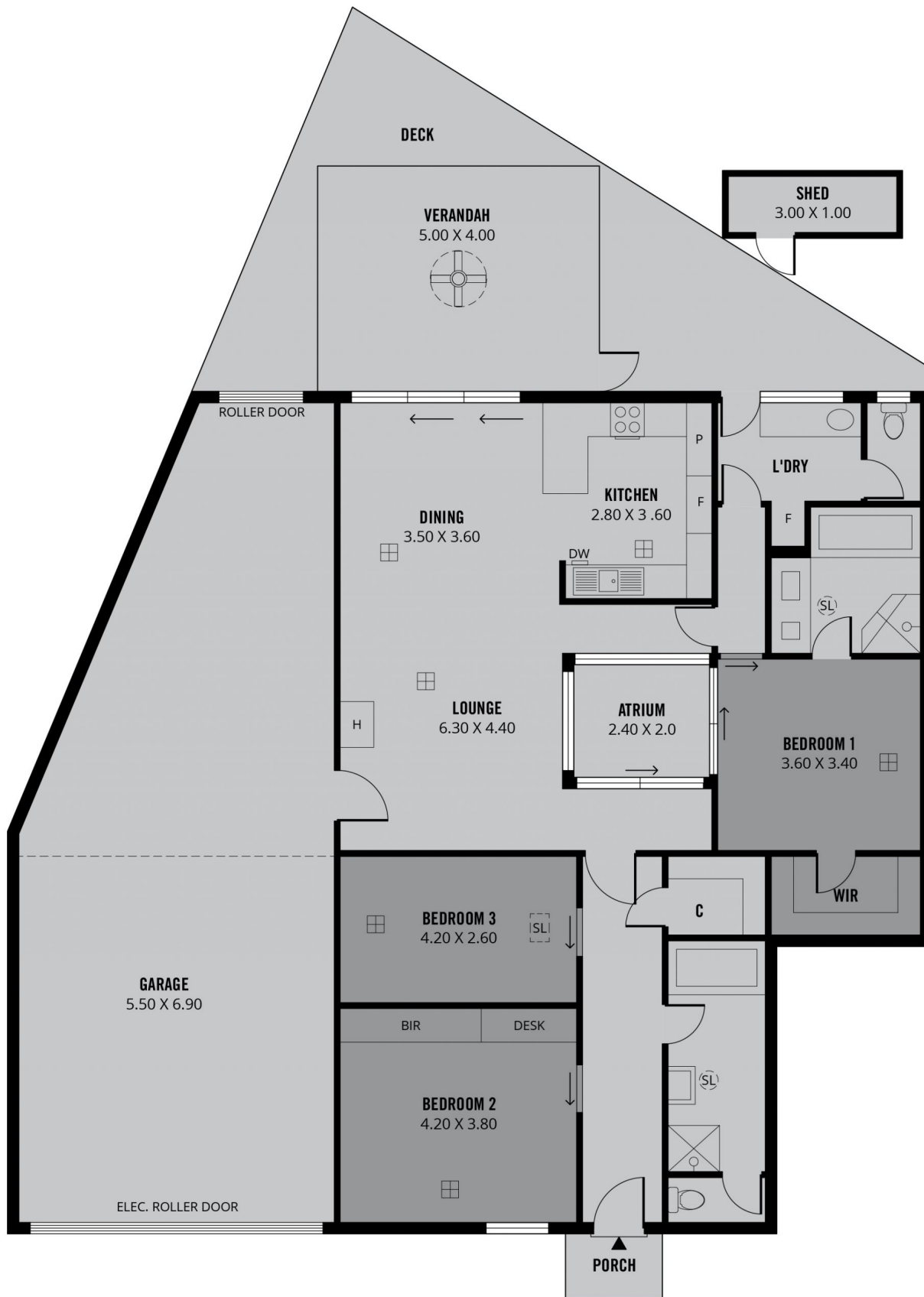

Scale in metres. This drawing is for illustration purposes only. All measurements are approximate and details intended to be relied upon should be independently verified.

Produced by **The Fotobase Group**