

# SCHINELLA.



8 & 8C Ulva Avenue Warradale SA

3  2  1 

NOW COMPLETE & READY FOR INSPECTION! BE QUICK - THESE WONT LAST!

Situated in a rapidly growing pocket in the thriving suburb of Warradale, these two brand new, custom built Torrens Titled homes provide stylish, easy care and contemporary living, desirable for first home buyers, downsizers or one to consider for the investment portfolio! Positioned in the highly esteemed Brighton High School Zone, enjoy absolute convenience in location, only a minute walk to Westfield Shopping Centre, SA Aquatic & Leisure Centre, public transport links and a short drive to Flinders University & Medical Centre.

Superbly designed with an attractive facade, functional

[For full version visit the website](https://www.schinellaproperty.com.au)

**Type** : House  
**Building Size** : 159 sqm  
**Land Size** : 283 sqm  
**View** : <https://www.schinellaproperty.com.au/6302329>



**Marco Schinella**  
08 8294 4484

<https://www.schinellaproperty.com.au>

# 8 & 8C ULVA AVENUE WARRADALE

## PER DWELLING

SITE AREA	283.8 m <sup>2</sup>
LIVING AREA	119.8 m <sup>2</sup>
GARAGE	22.2 m <sup>2</sup>
ALFRESCO	15.6 m <sup>2</sup>
PORTICO	1.9 m <sup>2</sup>
<b>TOTAL</b>	<b>159.5 m<sup>2</sup></b>
REAR YARD	68 m <sup>2</sup>

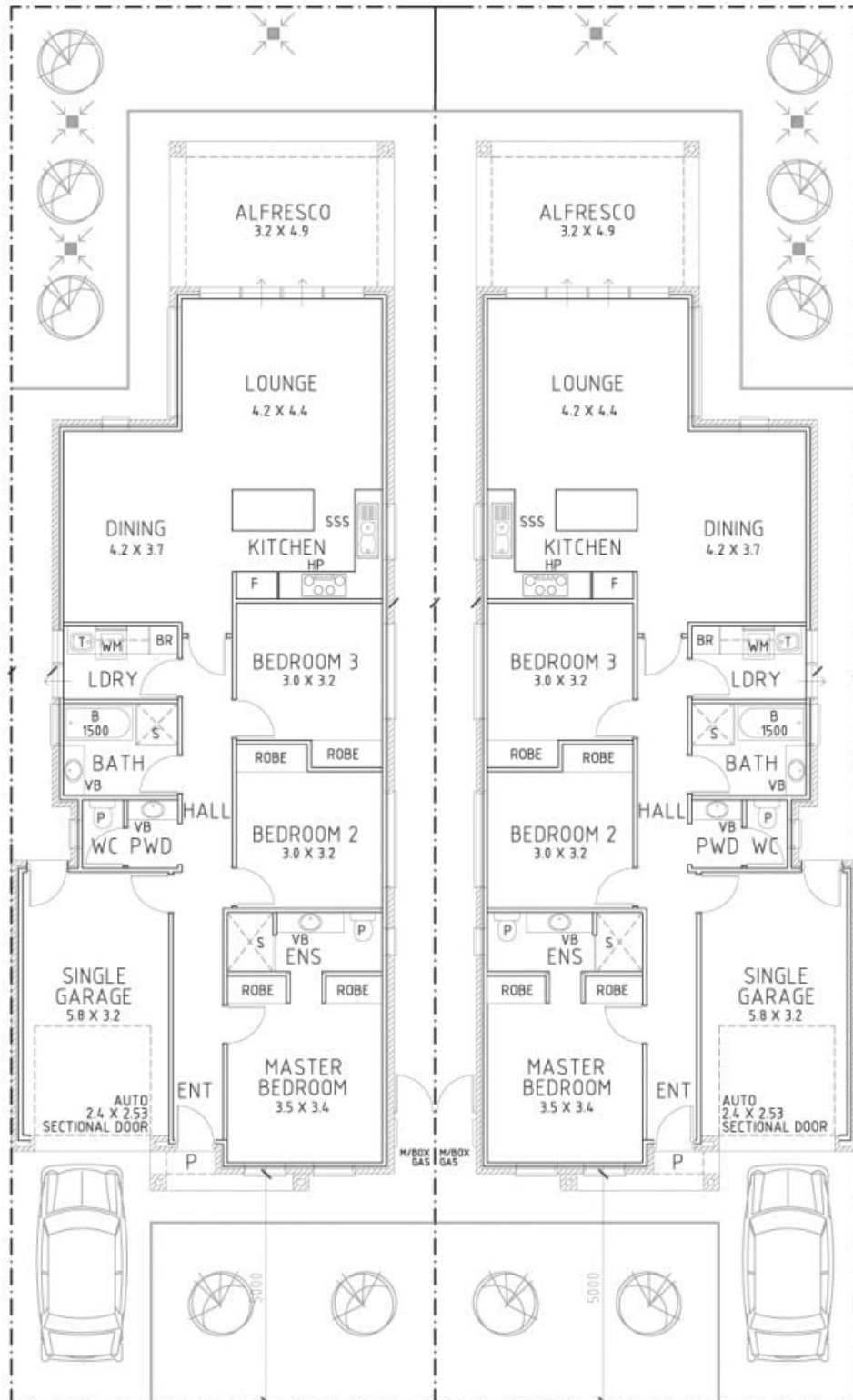

## ULVA AVENUE

All measurements are approximate. All interested parties should make & rely upon their own enquiries to determine whether or not this information is in fact accurate.