

# SCHINELLA.

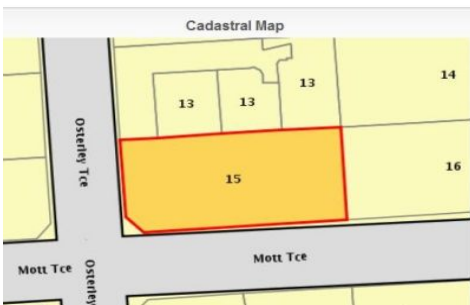

## 15 Osterley Terrace SEACLIFF PARK SA

3 1 2

Located on a great corner position, this large 975sqm (approx.) allotment has street frontages of 23 metres (approx.) wide and 42 metres (approx.) deep, offering keen developers, investors and renovators multiple options!

**Type** : House  
**Building Size** : 14 sqm  
**Land Size** : 975 sqm  
**View** : <https://www.schinellaproperty.com.au/6302107>

The Opportunities:

- Renovate the existing property and sub-divide the rear to sell or build!
- Demolish and build two new dwellings & profit!

(Subject to council consent)

The property:

[For full version visit the website](https://www.schinellaproperty.com.au)



**Pat Schinella**  
**08 8294 4484**

# 15 Osterley Terrace, Seacliff Park

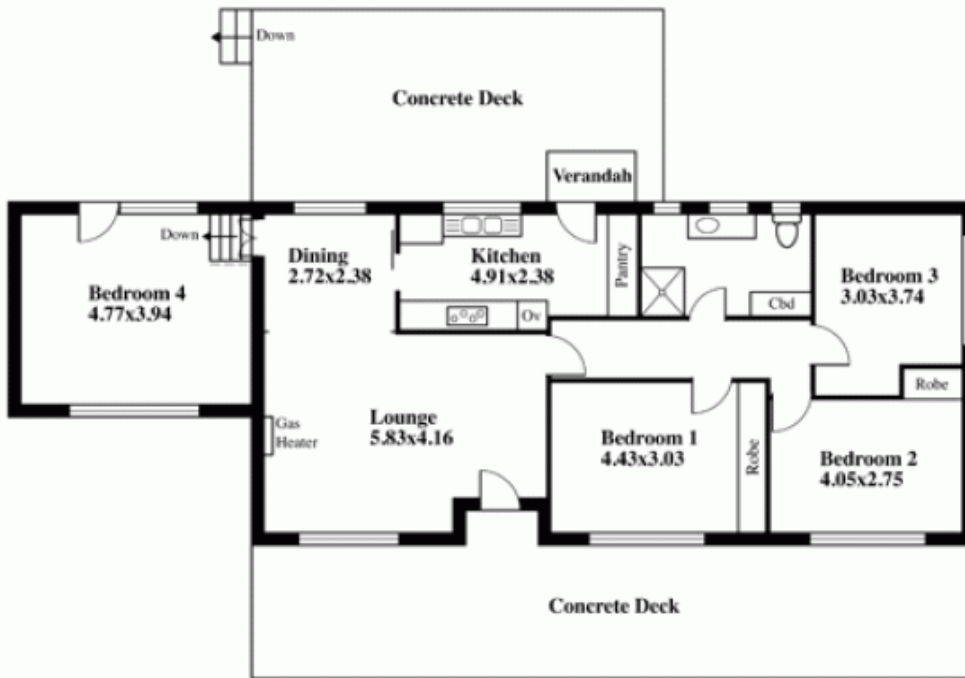

*This drawing is for illustration purposes only.  
 (Drawing is not to scale)  
 The drawing and the information contained is  
 not intended to be part of any contract. All  
 measurements are approximate and details intended  
 to be relied upon should be independently verified.*

**ESTIMATE OF AREA**  
 HOUSE 126.06 Square metres/ 13.55 Squares

Desk Top Image (V0414-14)