

SCHINELLA.



2/1 Hazel Street ASCOT PARK SA

2  **1**  **1** 

BUILT IN 1976, THIS 2 BEDROOM UNIT IS IDEALLY LOCATED TO ALL FACILITIES.

APPROXIMATELY 94 m2 OF LIVING AREA SITUATED IN A SMALL BLOCK OF 4

THE BEDROOMS ARE A GOOD SIZE WITH THE MAIN HAVING BUILT IN ROBES.

KITCHEN WITH AMPLE CUPBOARD SPACE AND GAS STOVE.

SEPARATE DINING AREA.

LARGE LOUNGE WITH GAS HEATING AND AIR

[For full version visit the website](https://www.schinellaproperty.com.au/6302096)

Type : Unit

View : <https://www.schinellaproperty.com.au/6302096>

<https://www.schinellaproperty.com.au>

2-1 Hazel Street, Ascot Park

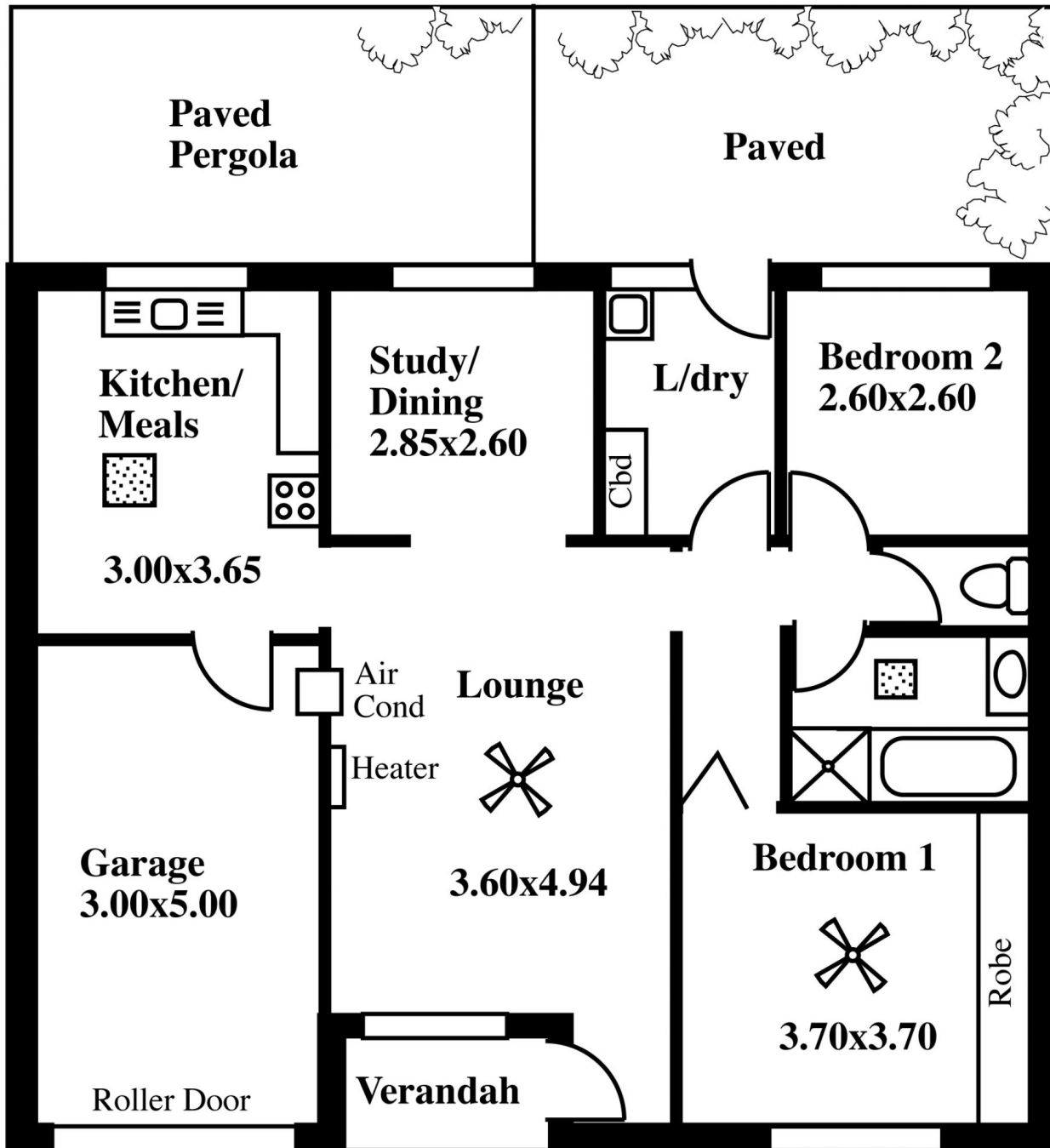

This drawing is for illustration purposes only
(Drawing is not to scale)

The drawing and the information contained is not intended to be part of any contract. All measurements are approximate and details intended to be relied upon should be independently verified.



ESTIMATE OF AREA
 97.59 Square metres/ 10.49 Squares
 (Including Garage)

Desk Top Image - (Y1113-23)