

SCHINELLA.

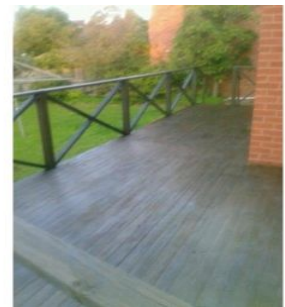

3 Sarah Close REYNELLA SA

4  1  1 

Perfectly positioned in a quiet cul-de-sac, sit this charming family home.

Enter the home through the grand separate entrance. A huge dining / living area opens to a stylish updated kitchen with gas cooking and lots of cupboard space, overlooking the large deck which is the perfect place to entertain or you can soak up the morning sun.

The separate lounge including gas heater awaits with plenty of windows to let in the natural light. Timber floors throughout complete the feel of warmth and space. Four good sized bedrooms are on offer, all with built in robes allowing the family to spread out.

Type : House

View : <https://www.schinellaproperty.com.au/6301978>

[For full version visit the website](https://www.schinellaproperty.com.au)

<https://www.schinellaproperty.com.au>

3 Sarah Close, Reynella

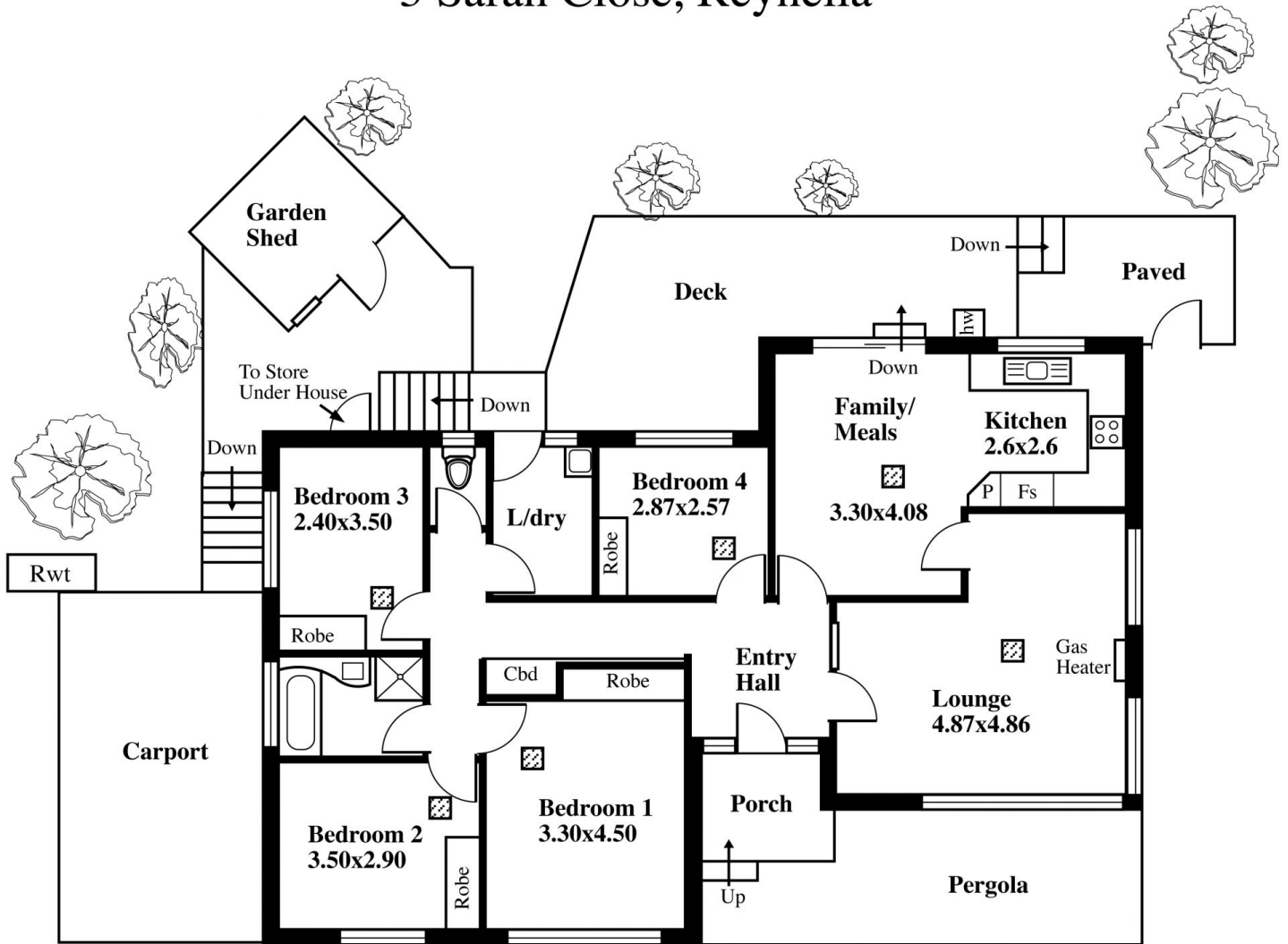

LEGEND	
	Air cond ducts

ESTIMATE OF LIVING AREA
117.53 Square metres/ 12.63 Squares

Desk Top Image - (Y0414-02)

This drawing is for illustration purposes only
(Drawing is not to scale)

The drawing and the information contained is not intended to be part of any contract. All measurements are approximate and details intended to be relied upon should be independently verified.