

# SCHINELLA.



1 & 2/15 Ann Street Rosewater SA

4  2  4 

Two units on one title! Set on a commanding corner allotment with three street frontages are these solid brick units, renovated and beautifully maintained. Walking distance to public transport and local shops.

UNIT 1: Featuring two good size bedrooms (main with BIR), excellent open plan kitchen/dining and living area, elegant bathroom and separate laundry. With polished timber floors, R/C split-system A/C, secure undercover parking and a neat and tidy low maintenance yard. Currently rented at \$230/week to a long-term tenant (8 Years).

UNIT 2: Good size main bedroom (with BIR), near new kitchen overlooking open living and dining area, R/C split

[For full version visit the website](https://www.schinellaproperty.com.au/57535)

**Type** : Block of Units  
**Price** : \$ 405,000  
**Land Size** : 430 sqm  
**View** : <https://www.schinellaproperty.com.au/57535>  
22



**Mick Mehicic**  
0412452262



**Damian Popowycz**  
0413 026 026

<https://www.schinellaproperty.com.au>

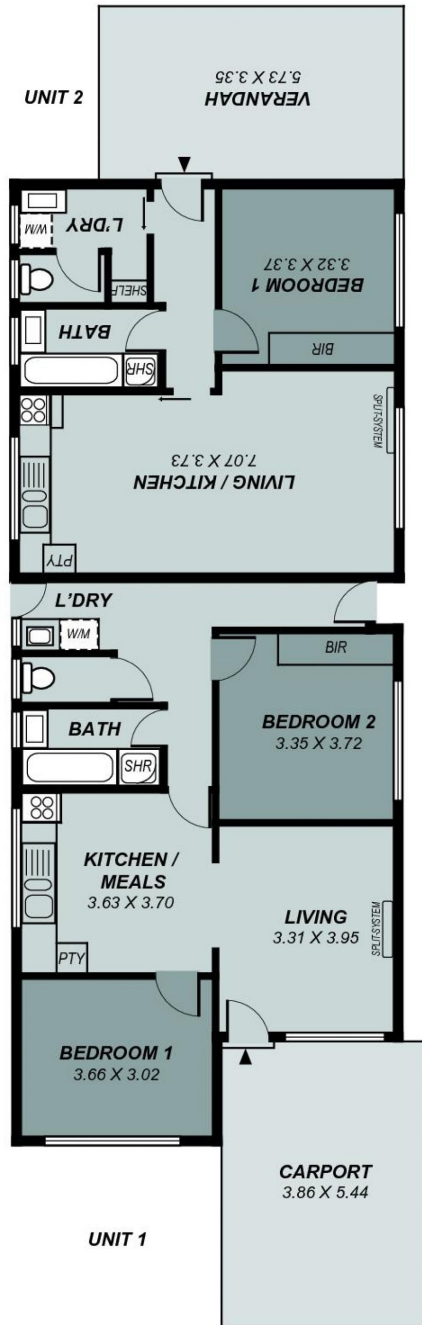
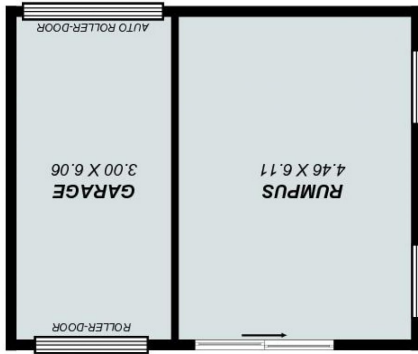

Area	m <sup>2</sup>
Living 1:	69.75
Living 2:	53.65
Garage:	18.18
Rumpus:	27.25
Verandah:	19.20
Carport:	21.00
<b>Total:</b>	<b>209.02</b>

This drawing is for illustration purposes only .  
 All measurements are approximate and details intended  
 to be relied upon should be independently verified.